

Recommended P.C.Board Layout
(Tolerance:±0.10)

SPECIFICATION:

1.Material&Finish:

Insulation Material: LCP UL94-V0 Black
Contact and Switch: Phosphor Bronze C5210,
Contact area 3u" Au over min 50u" Ni;
Solder tail 50u" tin over min 50u" Ni;
Shell:Stainless Steel SUS304

2.Electrical Characteristics

Current Rating: 1A
Contact Resistance: 50mΩ typical,100mΩ Max
Insulation Resistance: 1000MΩ Min At 500V DC

3.Mechanical Characteristics

Mechanical life: 10000 Mating Cycles Min
Contact Force:0.20-0.60N

4.Environmental Characteristics

Operating temperature: -40°C ~ +85°C
Operating humidity: 10% ~ 95%RH
Storage temperature: -40°C ~ +85°C
Storage humidity: 10% ~ 95%RH
Thermal shock: -40°C~ +85°C, 5cycles
Damp Heat: 40°C, 90% RH, 500HR.
Salt-mist: 35°C, 5%, NaCl, 48H.
IR Reflow:260°C 10 Sec Max

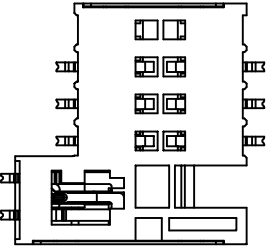

UNITS: mm		CSCONN		CSCONN PRECISE ELECTRONICS CO.,LTD	
GENERAL TOLERANCE		PART NO.(INTENDED USE)		TITLE:	
X. ° ±5°	0.X±0.25	CSI061516535001		SIM CARD 6+2P H=3.5MM	
X.1±2°	0.XX±0.2	APPD:		DWG NO.	
XX.±1°	0.XXX±0.1	CHKD: Skila		SIM CARD	
		DR: Kitty		SCALE SHEET REV	
				1:1 1 OF 1 A	