

(1.20)MINIMUM WORKING POSITION
 (1.40)NOMINAL WORKING POSITION
 (1.60)MAX WORKING POSITION

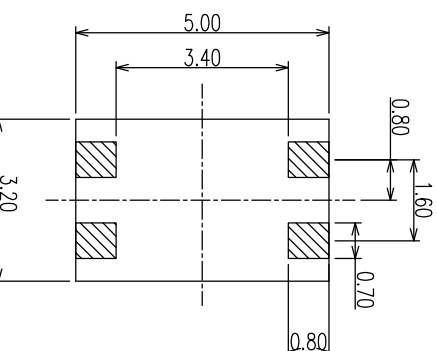

RECOMMENDED MATING PAD LAYOUT

RECOMMENDED PCB LAYOUT

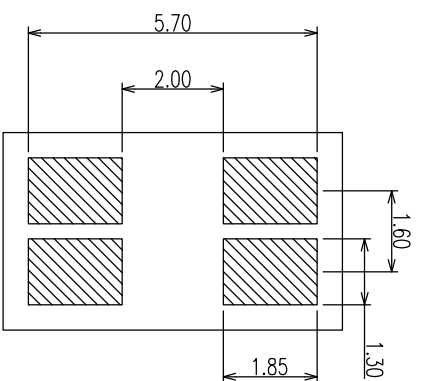
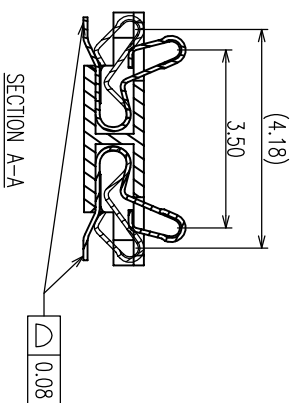

- NOTES:
- MATERIAL:
 - Housing: High Temperature Thermoplastic UL94V-0; Color Black.
 - Terminal: Copper Alloy.
 - SPECIALTY:
 - Rated current: 0.5A
 - Rated voltage: 30V
 - Contact Resistance: 50mΩ MAX
 - Insulation Resistance: 100MΩ MIN 100V DC
 - Dielectric withstanding voltage: 100V AC.
 - Solder ability: 235±5°C, 5±0.5s.
 - Durability: 5000 Cycles Min.
 - Operating condition: Temperature: -30°C~+80°C; Humidity: 80% R.H MAX

UNITS: mm		CSCONN		SHENZHEN CSCONN PRECISE ELECTRONICS CO.,LTD	
GENERAL TOLERANCE					
X ± 0.3	0.1 ± 0.3	PART NO.(RECOMMENDED)	TITLE: BATTERY 1.6MM 4P 1.2H 双排		
X ± 0.2	0.1 ± 0.2	CBA16041202001	DWG NO. BATTERY		
X ± 0.1	0.1 ± 0.1	APP: SKI1a	SCALE	SHEET	REV
X ± 0.5		CHK: Kitty	1:1	1 OF 1	A
		DR: Kitty			